

8A123a

6-32 x .375" on 2.00" DBC (3)

1.0" or 1.5"

3.61"

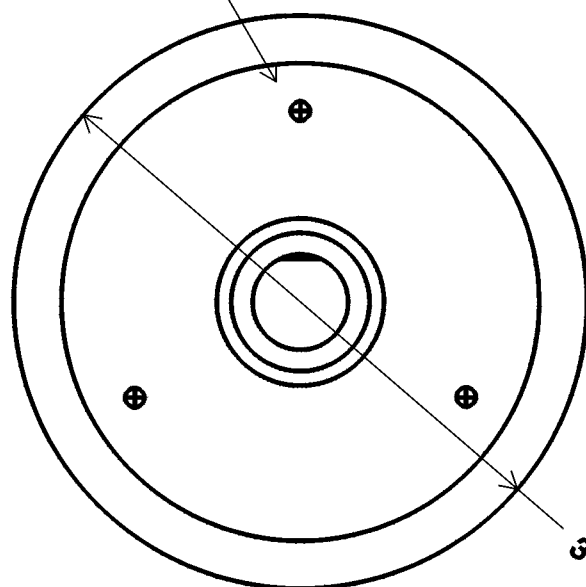

3.0"D

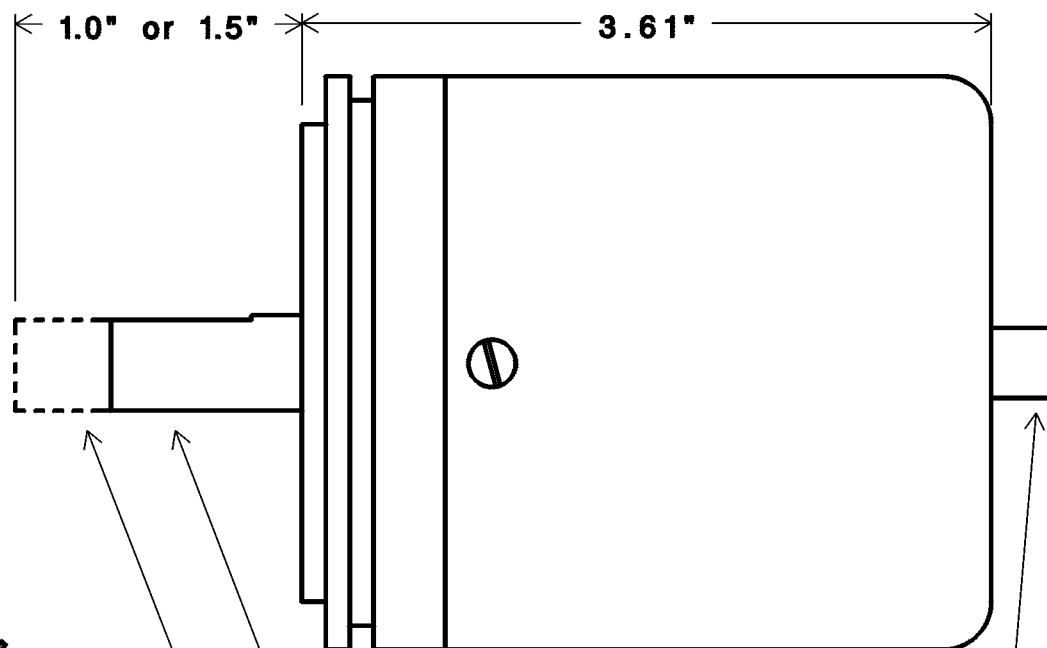

25 pin DB25P Connector

.500"D w/ .025" flat (see 34A030)

Short version is designated: 8A123-S

Pin	Output	Wire Color+
2	G8 (msb)	White
3	G7	Black/White
4	G6	Blue/Black
5	G5	Blue
6	G4	Green
7	G3	Green/Black
8	G2	Orange
9	G1	Red
10	G0	Red/Black
19	CW/CCW*	Orange/Black
21	Common	White/Black
22	7-24 vdc	Red/White
24	(not used)	Blue/White
	Shield	Green/White
	(not used)	Black

\* Apply logic 1 for cw, logic 0 for ccw count increase for shaft rotation. (Note: direction only changes when power is first applied.)

+ The first color listed is the wire body color. The second is the stripe color.

Rev	Description	Date	Tolerances	M123: R30 with 360 graycode, fwd/rev select, 1/2" shaft, DB25P Connector (see also 8A068)		
a	Add short version of shaft (8A123-S)	2/22/00	.XXXX ± .0005 .XXX ± .005 .XX ± .01 .X ± .015 Fractions ± 1/32 Angles ± 15 min. Runout ± .003 Unless otherwise specified	BY: TRD	MAT'L: See: 24A004, 32B073, 34A030	
				DATE: 5-5-99	FINISH: na	SCALE: 1 : 1
				PHOTOCRAFT, Inc. Elburn, Illinois 8A123a		