

MB-FB2B

Rigid Mounting Tether

DIMENSIONS

Shown with HS20 hollow shaft encoder.

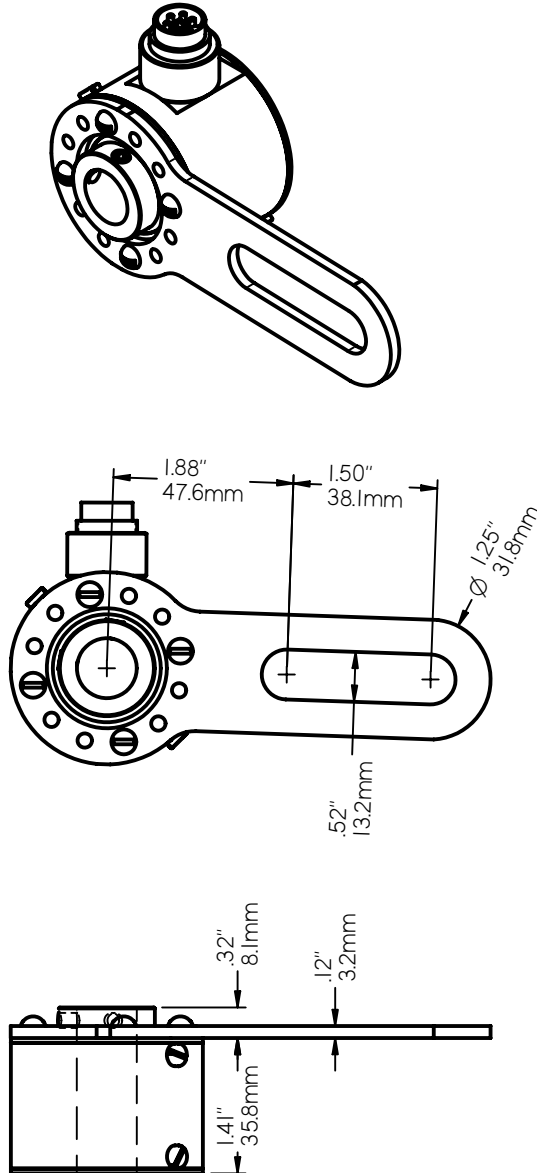

DESCRIPTION

Designed to tether the HS20 hollow shaft encoder and prevent it from rotating without rigidly attaching it to the motor frame. Ideally the tether is held in position by placing a pin parallel to the motor shaft through the tether's slot and fastening the pin to the motor frame. The pin prevents the encoder from rotating, and allows it to float on the motor shaft.

The MB-FB2B is made of 1/8" (3.2mm) thick aluminum. The tether should not be rigidly attached to the motor frame. Doing so will significantly reduce the life of the encoder's bearings.

Also, see our other tethers:

- MB-FB2 - .015" thick formed, flexible, stainless steel version of the MB-FB2B.
- MB-FB2A - .015" thick flat, stainless steel version of the MB-FB2B.

INSTALLATION

1. Fasten the MB-FB2B tether to the face of the encoder using the four 6-32 screws (supplied). The MB-FB2B mounting holes allow for the positioning of the tether in 30° increments.
2. Install a pin on the motor housing parallel to the motor shaft and 1.88" to 3.38" from the shaft center, such that it will engage the MB-FB2B slot when the encoder is installed.
3. Position the encoder onto the motor shaft such that the previously installed pin is in the MB-FB2B slot.

ORDERING INFORMATION

Part No.: MB-FB2B
(includes all parts shown in the parts list)

PARTS LIST

Qty	Description	Part No.
1	MB-FB2B rigid tether	500-MCH110
4	6-32 x 1/4" RH screws	550-SCR200



602 E. North Street 630-365-7148
Elburn, IL 60119, USA Fax: 630-365-7149
www.photocraftencoders.com