

MB-FL5

Encoder mounting bracket

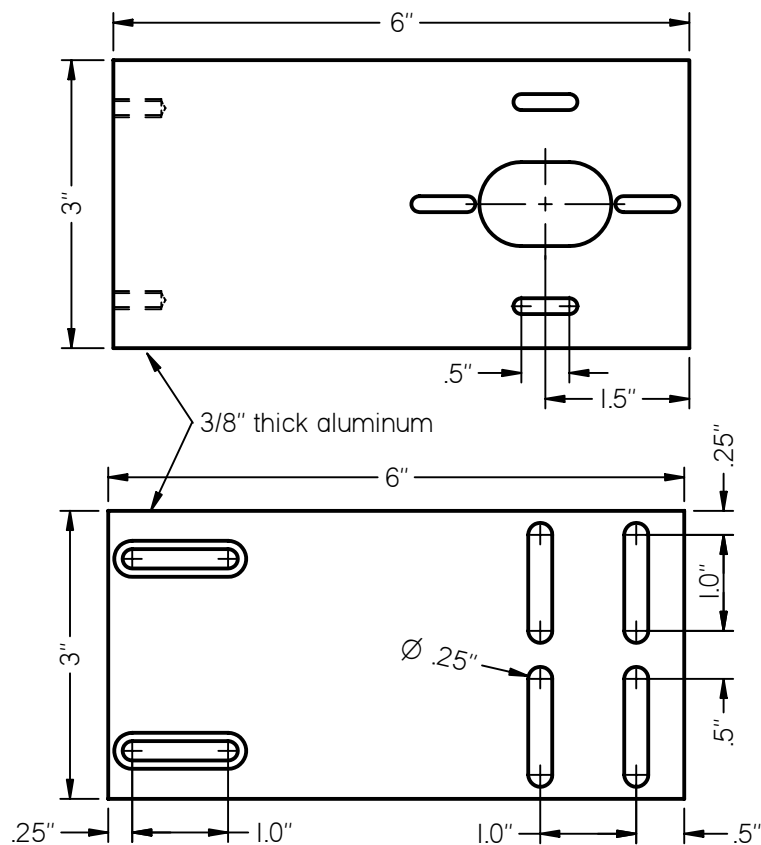
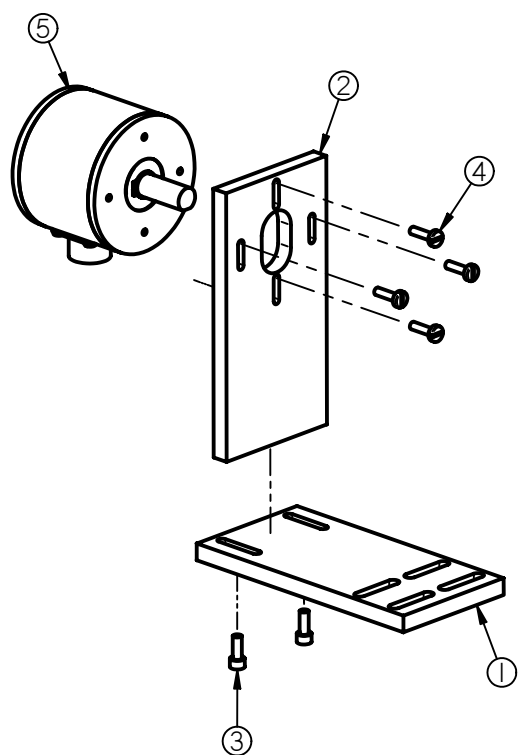

DESCRIPTION

The MB-FL5 provides a rigid mounting bracket for the RL encoder. During installation it can be adjusted in all three dimensions to optimize alignment with the mating shaft. Because it is a rigid mounting, we recommend the use of a flexible shaft coupling when directly coupling the encoder shaft to another shaft.

ORDER INFORMATION

Part No.: MB-FL5

(includes all parts in spare parts list except the RL encoder)

INSTALLATION

- 1. Assemble MB-FL5 mounting bracket as shown in the figure using the four .25" x 1" slots on the mounting base to attached the assembly to the machine frame. Do not tighten the screws.
- 2. Align the encoder shaft with the machine shaft. Use a flexible shaft coupling to couple the shafts.
- 3. After the two shafts are aligned, tighten all screws.

SPARE PARTS LIST

#	Description	Part No.	Qty
1	MB-FL5 mounting base	500-MCH100	1
2	MB-FL5 mounting plate	500-MCH099	1
3	Socket Head Cap Screw	550-SCR302	2
4	8-32 x .625" binder head screw	550-SCR307	4
5	RL.5 Encoder (1/2" shaft)		1

# see circled reference numbers in figure above



PO Box 25135 813-886-4000  
Tampa FL 33622-5135, USA 800-237-0946  
ttco.com • photocraftencoders.com