

MB-ST.312 Hollow Shaft Encoder Shaft Stubs

DESCRIPTION

The MB-ST.312 can be installed on the end of a conveyor roller to provide a mounting shaft for a hollow shaft encoder, such as the HS20 or HS25 encoders. The HS20 or HS25 should be ordered with a 5/16" shaft bore so it fits the MB-ST.312

INSTALLATION

1. Drill and tap a 1/4-20 hole, at least 1/2" deep, into the end of the conveyor roller. The hole must be centered and in-line with the conveyor roller axis so there is minimum wobble when the roller is rotating.
2. Insert the MB-ST.312 shaft stub. Tighten with a 5/32" hex key.
3. Install the HS20 or HS25 hollow shaft encoder onto the shaft stub and tighten the set screws.

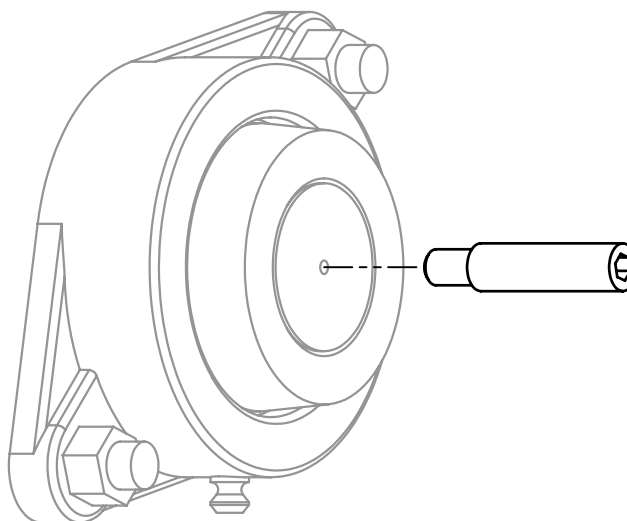

Figure 1: MB-ST.312 and conveyor roller bearing

DIMENSIONS

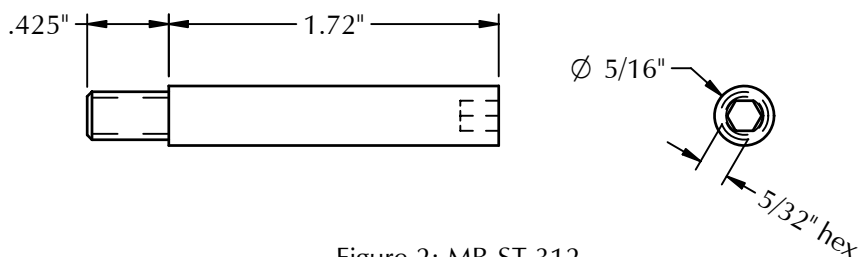

Figure 2: MB-ST.312



PO Box 25135 813-886-4000
Tampa FL 33622-5135, USA 800-237-0946
ttco.com • photocraftencoders.com