

# MB-ST-M10 Hollow Shaft Encoder Shaft Stubs

## DESCRIPTION

The MB-ST-M10 can be installed on the end of a conveyor roller to provide a mounting shaft for a hollow shaft encoder, such as the HS20 or HRL encoders. The HS20 or HRL should be ordered with a 10mm shaft bore so it fits the MB-ST-M10.

## INSTALLATION

1. Drill and tap an M8 x 1.25mm hole, at least 13mm deep, into the end of the conveyor roller. The hole must be centered and in-line with the conveyor roller axis so there is minimum wobble when the roller is rotating.
2. Insert the MB-ST-M10 shaft stub. Tighten with a 5mm hex key.
3. Install the HS20 or HRL hollow shaft encoder onto the shaft stub and tighten the set screws.

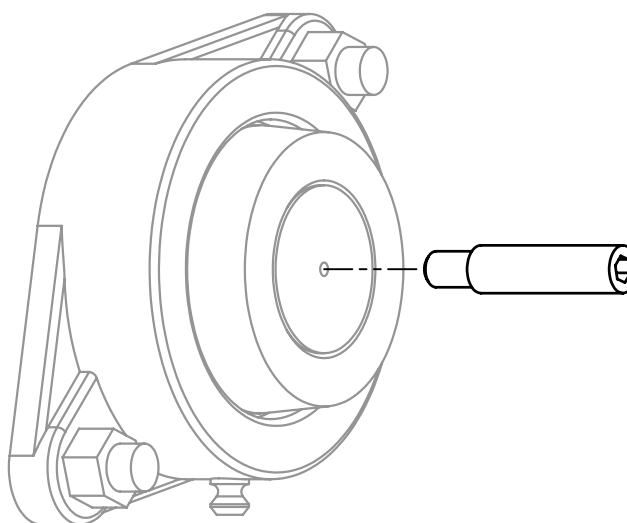

Figure 1: MB-ST-M10 and conveyor roller bearing

## DIMENSIONS

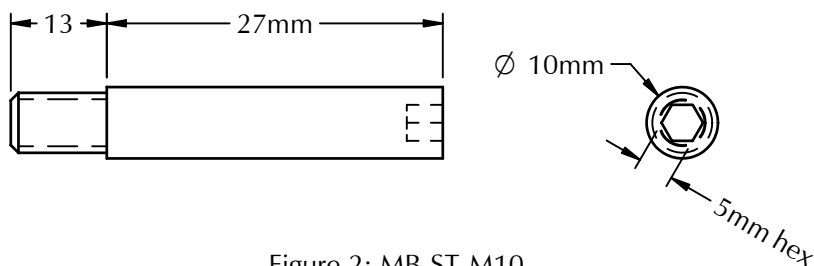

Figure 2: MB-ST-M10



PO Box 25135 813-886-4000  
Tampa FL 33622-5135, USA 800-237-0946  
[ttco.com](http://ttco.com) • [photocraftencoders.com](http://photocraftencoders.com)